



BEVERAGE-AIR

Project: _____	AIA#
Item: _____	SIS#
Location: _____	
Approved: _____	

MARKETEER™ MERCHANDISERS
 MT72 Black Hinged Door Model
 Hydrocarbon Series

MODEL:
MT72-1B

MT72™ MERCHANDISER: HINGED DOOR MODEL



5 Year Parts/Labor Warranty Available
7 Year Compressor Warranty

CABINET CONSTRUCTION

- Standard cabinet exterior finish is prepainted black steel
- Heavy duty interior construction includes white coated steel
- Mechanical temperature control
- Modern one piece grille
- Double pane lowE argon filled glass doors feature outside pane that is tempered for added safety
- Door locks standard
- Self-closing hinged glass doors features, pocket door handles
- LED lighting
- Fifteen (15) epoxy coated shelves
- Leveling feet

OPTIONS & ACCESSORIES

- 3 Year parts/labor standard, additional 2 year warranty available
- Extra shelves and clips
- 3" Casters
- Visislide shelving kit

REFRIGERATION SYSTEM

- Uses environmentally friendly, energy efficient R290 refrigerant, and meets all regulatory requirements for CARB, SNAP, DOE & more
- Condenser is designed to be low maintenance, and energy efficient
- Automatic, non-electric defrost
- Epoxy coated evaporator coil
- Maintains product temperatures between 32°F and 44.6°F



Please verify qualifying units by visiting:
www.energystar.gov/cfs

3779 Champion Blvd., Winston-Salem, NC 27105
 1-888-845-9800 Fax: 1-336-245-6453
 Beverage-Air.com Sales@bevair.com



BEVERAGE-AIR

Glass Hinged Door Model Model: MT72-1B

MODEL	MT72-1B
EXTERNAL DIMENSIONAL DATA	
Width Overall	78 ¾"
Depth Overall	33 ⅝"
Height Overall	79 ⅜"
Number of Doors	3
Depth with Door Open 90°	59 ½"
INTERNAL DIMENSIONAL DATA	
NET Capacity (cubic ft.)	66.3
Capacity 20 oz	840
Internal Width Overall (in)	74 ⅝"
Internal Depth Overall (in)	27 ¼"
Internal Height Overall (in)	60 ⅛"
Internal Height Useable (in)	52 ⅝"
Number of Shelves	15
ELECTRICAL DATA	
Full Load Amperes 115/60/1	13.6
REFRIGERATION DATA	
Horsepower	(2) 1/2
Energy Consumption	5.004 Kwh / 24h
Capacity (BTU/Hr)	7230
Heat Rejection (BTU/Hr)	10,845
Charge (lbs/grams)	0.3528/160
WEIGHT DATA	
Gross Weight - Crated	828.9 lbs
Height - Crated	82 ¾"
Width - Crated	81 ¼"
Depth - Crated	33 ¾"

Model Views

Clearances: 4" Top, Rear, Left and Right Side

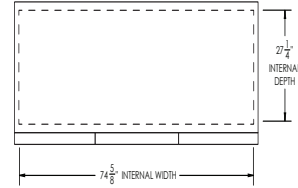

PLAN VIEW

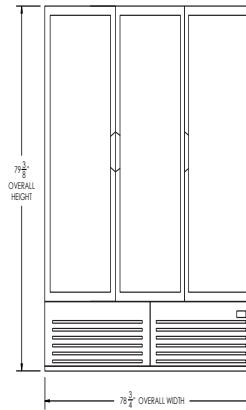

ELEVATION VIEW

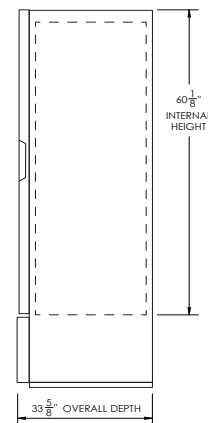

SIDE VIEW

ELECTRICAL CONNECTION



115/60/1
NEMA 5-15P

Unit pre-wired at factory and include 8' long cord and plug set.

